

- REFERENCE NOTES:
- 1 #10 BARE COPPER GROUND LOOP AND T-CONNECTORS FOR GROUND EXTENSION PROVISION TO METALLIC CONTAINERS IN ROOM. RUN GROUND LOOP HORIZONTALLY AT +90° AND TO CLEAR DOORS. SUPPORT AS REQUIRED.
 - INSTALL IMMEDIATELY BELOW BENCH TOP.
 - RUN CONDUIT BELOW BENCH TOP.
 - 3/4" C, 1 #10 TO GROUND BUS OF PANEL 1LPF.
 - CEILING MOUNTED, DROP DOWN TO OSHA CABINETS WITH 3/4" C 1 #10 AND GROUND OSHA CABINETS AS REQUIRED. COORDINATE LOCATION.

unals
Earl Wells Associates
Laboratory Design Consultants
5348 Carroll Canyon Road
San Diego, California 92121
(619) 457-2400

FIRST FLOOR
SCALE: 1/4" = 1'-0"

DRAWING REVISIONS:		
NO.	DATE	REMARKS

AREA THREE
AS BUILT

DATE: 5/16/94
PROJECT#: 8962
DESIGNED BY: JSB
DRAWN BY: MS
CHECKED BY: JSB

SHEET NO.:

LE3

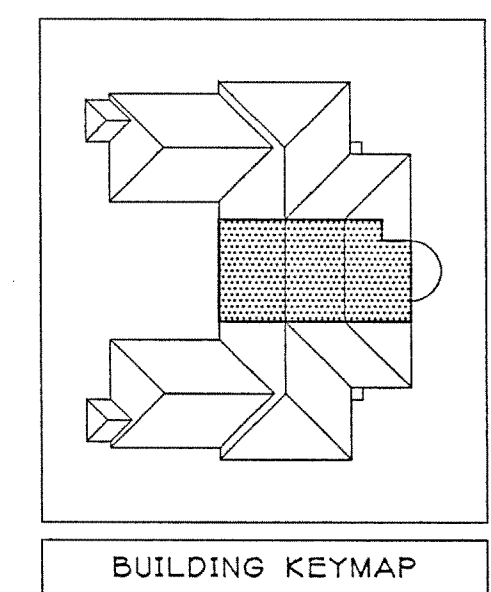

JEFFERIES AND FARIS ASSOCIATES
ARCHITECTS • PLANNERS
SEA TOWERS, SUITE 201
2002 EASTWOOD ROAD
WILMINGTON, N.C. 28403
TEL: 910.256.6833
FAX: 910.256.9088

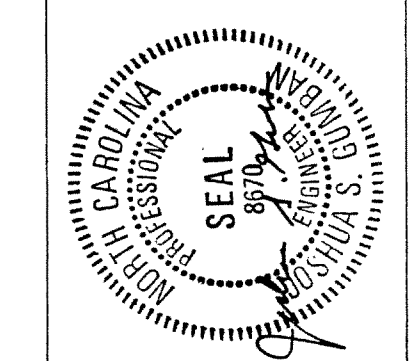

SCIENCE BUILDING
UNIVERSITY OF NORTH CAROLINA AT WILMINGTON
CODE 44300 ITEM 301 ID#6089280801A

SHEET TITLE:

FIRST FLOOR PLAN - AREA THREE
WEST

